

PT2121-51ST-V2Q1

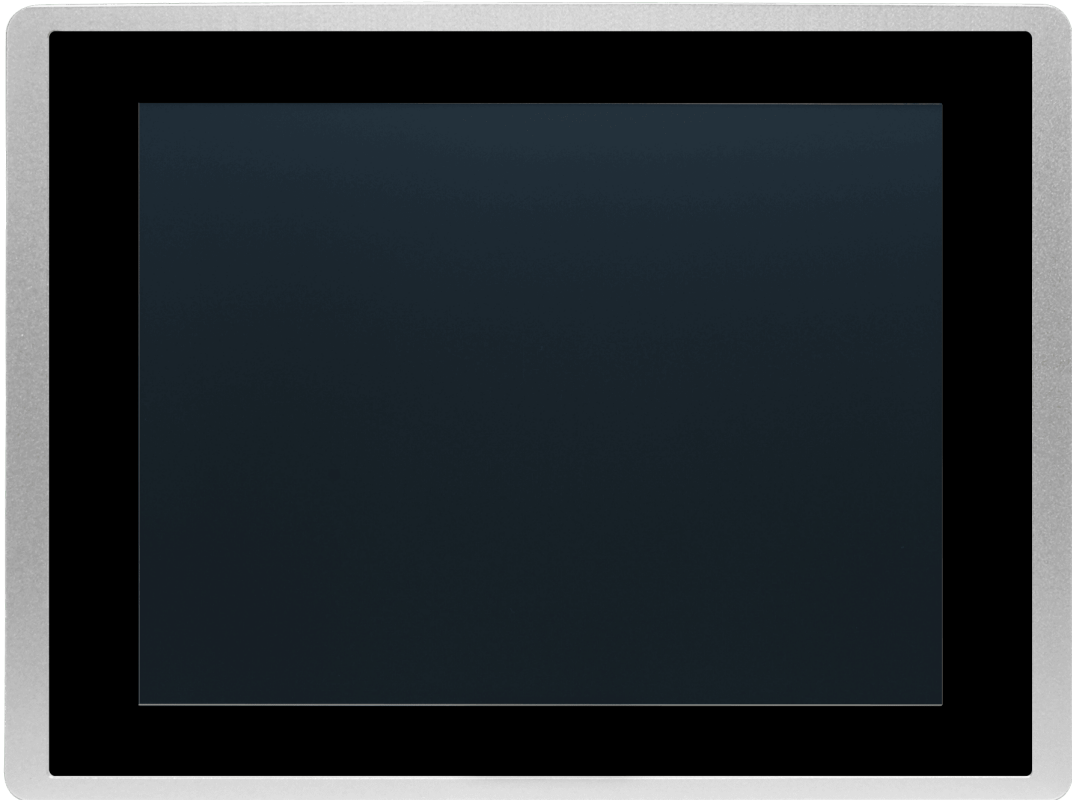

Product Specification

Touch	Resistivo
Feature	-
Performance	-
Inch	12,1"
Form Factor	4:3
Display	LCD
Resolution	1024 x 768
Colors	16bit
LCD view angles (T/B/L/R)	-
Brightness	500cd/m2
Backlight	LED
Display life	50000h
CPU	RISC ARM9 300MHz
RAM	64MB
Storage	64MB
Battery backup Memory	128KB
RTC	Built in
SD card	-
Ethernet	1x 10/100Mb/s
USB Host	USB Type A
Programming port	USB Type B
COM 1	RS232

COM 2	RS422/485
COM 3	RS485
COM 4	RS485
COM 5	RS485
Power Supply	24Vdc \pm 10% (isolated)
Power Consumption	20W
Storage Temperature	-10 ~ 60°C
Operating Temperature	-10 ~ 60°C
Relative Humidity	10 - 90%RH (non-condensate)
Vibration	Random vibration 1Grms (5 ~ 500Hz)
Protection Degree (Front)	IP66
Protection Degree (Back)	IP20
Lightning	-
Case Material	ABS
Mounting	Panel-Mount
Cutout	302 x 228mm
Dimension	335,4 x 245,8 x 66,4mm
Weight	2000g
CE	EN61000-6-2, EN61000-6-4
RoHS	Compliant
UL	Optional

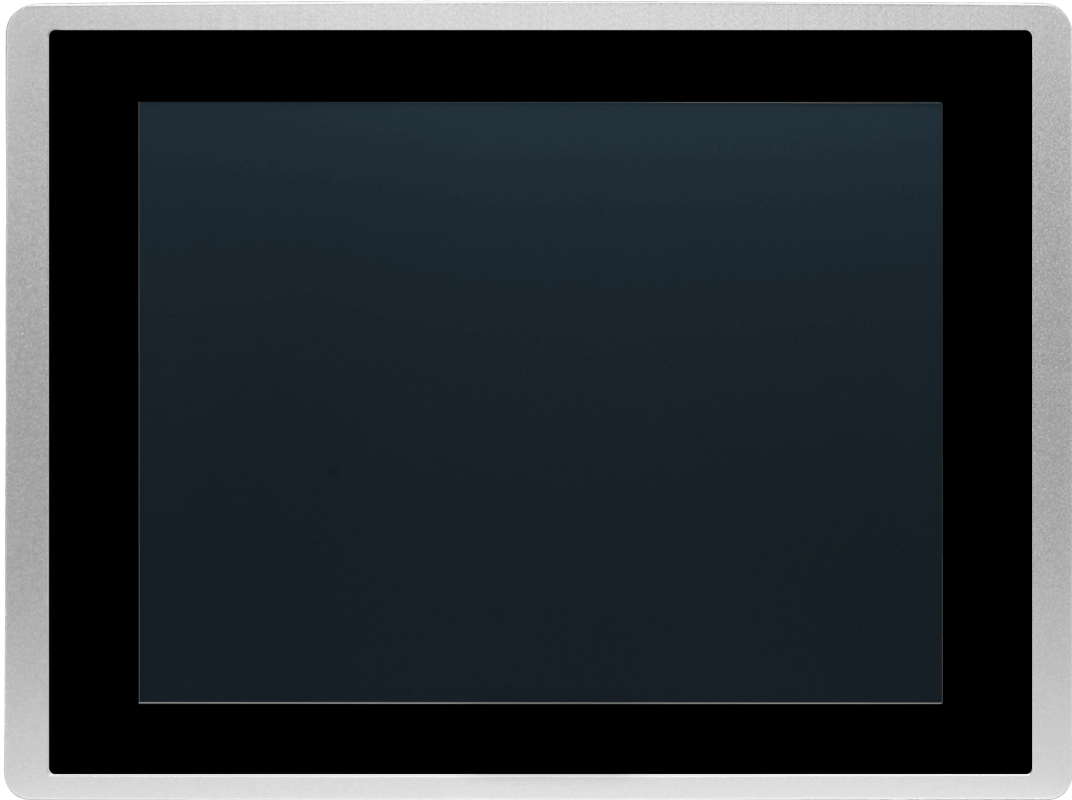



PT2 series HMI panels / PT2 系列人機介面 / PT2 系列人機界面

Outlet dimension / 外觀尺寸 / 外觀尺寸

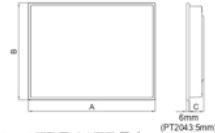

Cut out dimension / 開孔尺寸 / 開孔尺寸

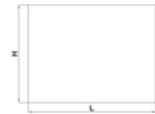

Model	A	B	C*	L	H
PT2043	128mm/5.08"	103mm/4.06"	33mm/1.30"	118.5mm/4.67"	92.5mm/3.64"
PT2070(F)	189.6mm/7.46"	144.9mm/5.70"	36.1mm/1.42"	175mm/6.89"	132.5mm/5.22"
PT2070(L)	203.8mm/8.02"	148.8mm/5.90"	37.1mm/1.46"	191.5mm/7.54"	130mm/5.43"
PT2080	231.6mm/9.12"	176.3mm/6.94"	43.4mm/1.70"	221mm/8.70"	163.5mm/6.44"
PT2100 / PT2104	270.1mm/10.63"	212.1mm/8.35"	43.4mm/1.71"	259mm/10.2"	201mm/7.91"
PT2120 / PT2121	335.4mm/13.20"	245.8mm/9.68"	66.4mm/2.61"	302mm/11.89"	229mm/8.98"
PT2150	398.1mm/15.71"	297.8mm/11.72"	63.4mm/2.50"	364.5mm/14.34"	283mm/11.14"

* Includes 5-Pin terminal block height / 產品高度包含5Pin端子 / 產品高度包含5Pin端子

Function view / 功能配置圖 / 功能配置圖

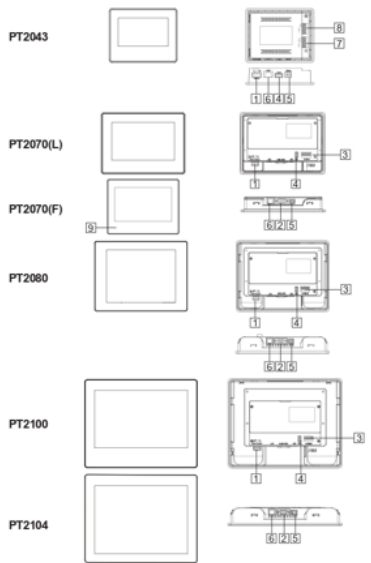

3

Installation drawing for locks / 固定件安裝示意圖 / 鎖具安裝示意圖

Plastic locks / 塑膠安裝固定件 / 塑膠安裝鎖具

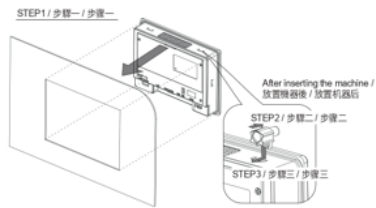

Metal locks / 金屬安裝固定件 / 金屬安裝鎖具

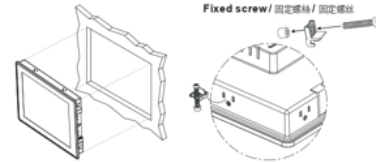

Tighten each fixing screw until the bezel corner gets in contact with the panel.
使用固定螺絲時請注意不要鎖太緊，以免壓到造成其他損傷。
使用固定螺絲時請注意不要鎖太緊，以免壓到造成其他損傷。
Suggested torque for fixing screws: 0.25-0.34Nm / 固定螺絲扭力建議值: 0.25-0.34Nm

2

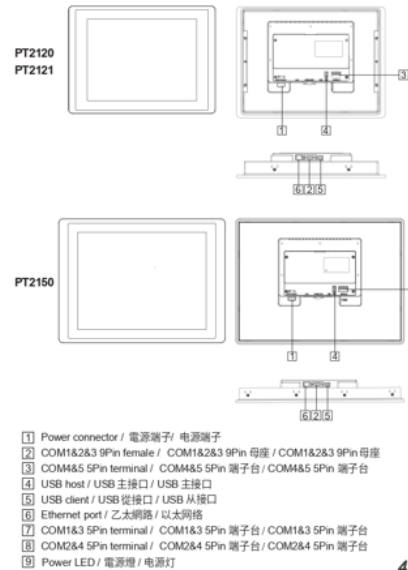

4

Power supply / 電源供應 / 電源供應

Powered by a Low Voltage / Limited Energy power source
 以低電壓提供電力/限制能源電源 / 以低電壓提供電力/限制能源電源

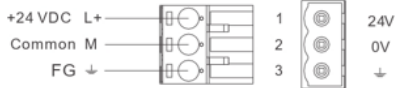

Do not open the rear cover of the panel when power is applied.
 電源通電時請勿拆開後殼 / 電源通電時請勿拆開後殼

Be sure that the power supply has enough power capacity for the operation of the equipment.
 確保設備定電壓設備的電源能力符合產品硬體規範。
 這電時請確定電源設備的電源能力符合產品硬體規範。

- PT2043: 24VDC / 0.4A
- PT2070(F) & PT2070(L) & PT2080 & PT2100 & PT2104 & PT2120 & PT2121 & PT2150: 24VDC / 0.8A

Dispose of batteries / 電池處理 / 電池處理

PT2043 / 2070 - L-F -- &
 PT2070 / 2080 / 2100 / 2104 - L-U -- &
 PT2100 / 2121 / 2150 - L-V -- &

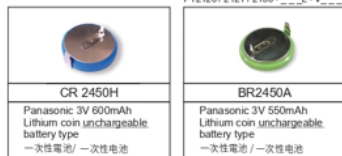

Dispose of batteries according to local regulations.
 依照電池的處理規範使用所在地之規範辦理廢棄電池處理方式。
 處理電池的處理規範使用所在地之規範辦理廢棄電池處理方式。

Pin diagram / 腳位圖 / 腳位圖

Model	Terminal	Pin	Description
PT2043	21S / 21S (Optional)	1	RS422 TXD+ / RS485+ (COM2)
	31S / 31S (Optional)	2	RS232 RXD (COM1)
	41S	3	RS232 TXD (COM1)
	51S	4	RS422 RXD (COM2)
PT2070(F) & PT2070(L) & PT2080 & PT2100 & PT2104 & PT2120 & PT2121 & PT2150	21S / 21S (Optional)	1	RS422 TXD+ / RS485+ (COM2)
	31S / 31S (Optional)	2	RS232 RXD (COM1)
	41S	3	RS232 TXD (COM1)
	51S	4	RS422 RXD (COM2)
PT2043	COM1 & COM3	5	SD
	COM2	6	RS422 TXD- / RS485- (COM2)
	COM2 & COM4	7	RS485- (COM3)
	COM2 & COM4	8	RS422 RXD (COM2)
PT2070(F) & PT2070(L) & PT2080 & PT2100 & PT2104 & PT2120 & PT2121 & PT2150	COM1 & COM3	5	SD
	COM2	6	RS422 TXD- / RS485- (COM2)
	COM2 & COM4	7	RS485- (COM3)
	COM2 & COM4	8	RS422 RXD (COM2)
PT2043	COM1 & COM3	9	RS422 RXD (COM2)
	COM2	10	RS485+ (COM3)
	COM2 & COM4	11	RS422 TXD (COM1)
	COM2 & COM4	12	RS232 RXD (COM1)

Battery replacement installation / 替代電池安裝說明 / 替代電池安裝說明

Please scan QR Code to download the installation guide.
 請掃描QR Code下載說明文件 / 請掃描QR Code下載說明文件

- * Note: It will affect the product warranty. If open the rear cover and damage the "Void if torn" Warranty label. Please contact us for details.
- * 注意: 若於產品保固期間內自行拆開後殼造成「撕毀保固無效」貼紙損毀將會影響產品保固。
- * 注意: 若於產品保固期間內自行拆開後殼造成「撕毀保固無效」貼紙損毀將會影響產品保固。



<https://reurl.cc/9WZqM>

The products have been designed for use in an industrial environment in compliance with the 2014/30/EU directive.
 本產品適用於工業環境並符合2014/30/EU標準 / 本產品適用於工業環境並符合2014/30/EU標準

- EN IEC 61000-6-4: 2019
- EN IEC 61000-6-2: 2019
- BS EN IEC 61000-6-4: 2019
- BS EN IEC 61000-6-2: 2019
- EN 61000-3-2: 2014
- IEC 61000-4-2: 2008
- IEC 61000-4-3: 2008
- EN 61000-3-3: 2013
- BS EN 61000-3-3: 2013
- EN IEC 61000-6-2: 2019
- BS EN IEC 61000-6-2: 2019
- EN IEC 61000-6-3: 2019
- IEC 61000-6-3: 2019
- EN 61000-6-3: 2013
- BS EN 61000-6-3: 2013
- EN IEC 61000-6-3: 2019
- BS EN IEC 61000-6-3: 2019

The installation of these devices into residential, commercial and light-industrial environments is allowed only special measures are taken in order to get the conformity to IEC-61000-6-3
 本產品若安裝於住宅、商業及輕工業的環境時，必須加裝特殊措施以符合IEC-61000-6-3 / 本產品若安裝於住宅、商業及輕工業的環境時，必須加裝特殊措施以符合IEC-61000-6-3

NEMA Certification: NEMA Type 4X Indoor Use Only

Reproduction of the contents of this copyrighted document, in whole or part without written permission of Ceramate Technologies Inc. is prohibited.
 本文件內容僅為Ceramate Technologies Inc.所有，未經本公司同意，請勿自行複製、拷貝或重印本文件內容。本文件內容僅為Ceramate Technologies Inc.所有，未經本公司同意，請勿自行複製、拷貝或重印本文件內容。

CAUTION

- Indoor use and pollution degree II, it must be wiped with a dry cloth for cleaning up the labeling.
- Please be used qualified power supply by SELV or double insulation of UL60950 or UL61010-1 or UL61010-2-201 standards.
- UL61010-2-201: Shall be mounted in the Industrial Control Panel, and the ambient temperature does not exceed 60 degrees C.
- If the equipment is used in a manner not specified by the manufacturer, the protection provided by the equipment may be impaired.
- We suggest using the cable type - AWG (American Wire Gauge) 18-24 and the corresponding pin type cable terminals.
- We suggest used torque value 4.60 lb-in, do not use excessive force when fixing wiring.
- Altitude: up to 2000 m
- Maximum ambient temperature rated:
 PT2043, PT2070, PT2080, PT2100, PT2104: 60 degree C /
 PT2120, PT2121, PT2150: 70 degree C
- Minimum ambient temperature rated - 10 degree C
- Input Wiring Rating: Min. 90 degree C

ATTENTION

- En cas d'utilisation dans un intérieur soumis à une pollution degré II, l'équipement doit être nettoyé à l'aide d'un tissu sec.
- L'alimentation utilisée doit respecter la norme SELV ou avoir une double isolation de type UL60950, UL61010-1 ou UL61010-2-201.
- UL61010-2-201: Doit être monté dans une armoire industrielle dont la température ambiante ne dépasse pas 60 degrés Celsius.
- En cas d'utilisation non conforme ou non spécifiée par le fabricant, la protection de l'équipement peut être inadéquate.
- Nous suggérons d'utiliser un type de câble AWG (American Wire Gauge) 18-24 avec les bornes correspondantes.
- Le couple de serrage recommandé pour les vis des bornes est de 4.60 lb-in, ne pas utiliser une force excessive.
- Altitude: jusqu'à 2000 m
- Température ambiante maximale évaluée:
 PT2043, PT2070, PT2080, PT2100, PT2104, PT2104: 60 degree C /
 PT2120, PT2121, PT2150: 70 degree C
- Température ambiante minimale nominale - 10 degree C
- Puissance du câblage d'entrée: min. 90 degrés C

Ceramate Technologies Inc
 7F-1, No. 168, Luancheng Rd, Zhonghe Dist.,
 New Taipei City 235, Taiwan (R.O.C.)