

PT2070-WST4B-F8R1

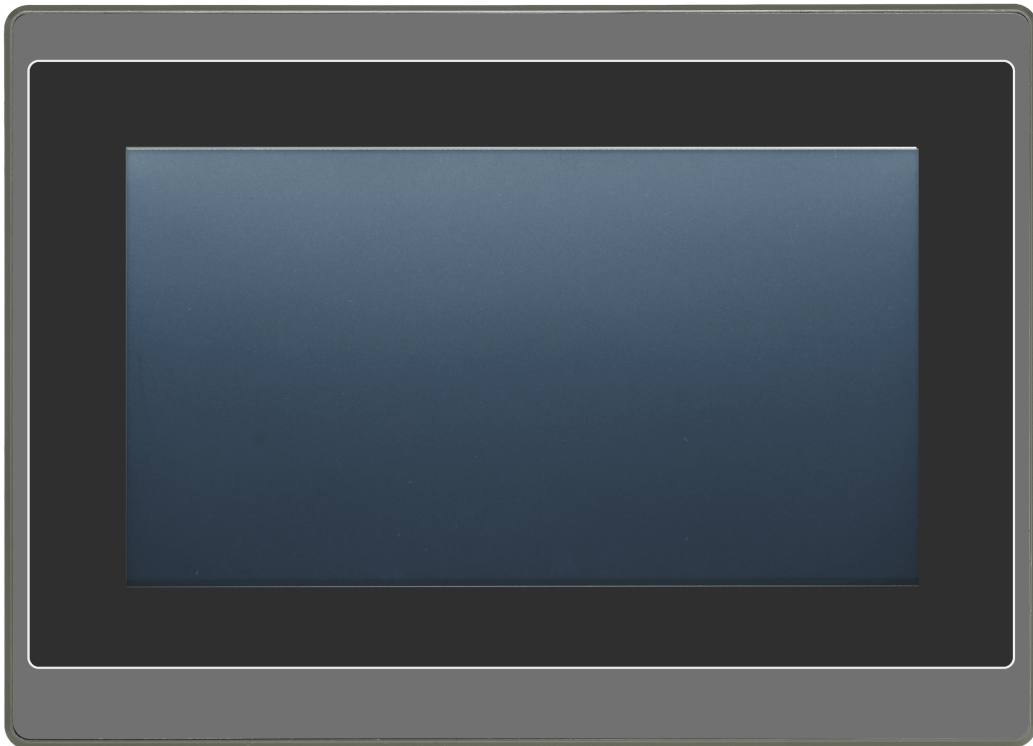

Product Specification

Touch	Resistivo
Feature	-
Performance	-
Inch	7,0"
Form Factor	16:10
Display	LCD
Resolution	800 x 480
Colors	16bit
LCD view angles (T/B/L/R)	-
Brightness	400cd/m2
Backlight	LED
Display life	20000h
CPU	RISC ARM9 300MHz
RAM	64MB
Storage	64MB
Battery backup Memory	128KB
RTC	Built in
SD card	Micro SD
Ethernet	1x 10/100Mb/s
USB Host	USB Type A
Programming port	USB Type B
COM 1	RS232/422/485

COM 2	RS232/485
COM 3	RS232
COM 4	-
COM 5	-
Power Supply	24Vdc \pm 10% (isolated)
Power Consumption	20W
Storage Temperature	-10 ~ 60°C
Operating Temperature	-10 ~ 60°C
Relative Humidity	10 - 90%RH (non-condensate)
Vibration	Random vibration 1Grms (5 ~ 500Hz)
Protection Degree (Front)	IP66
Protection Degree (Back)	IP20
Lightning	-
Case Material	ABS
Mounting	Panel-Mount
Cutout	175 x 132,5mm
Dimension	189,6 x 144,9 x 30,3mm
Weight	550g
CE	EN61000-6-2, EN61000-6-4
RoHS	Compliant
UL	Optional

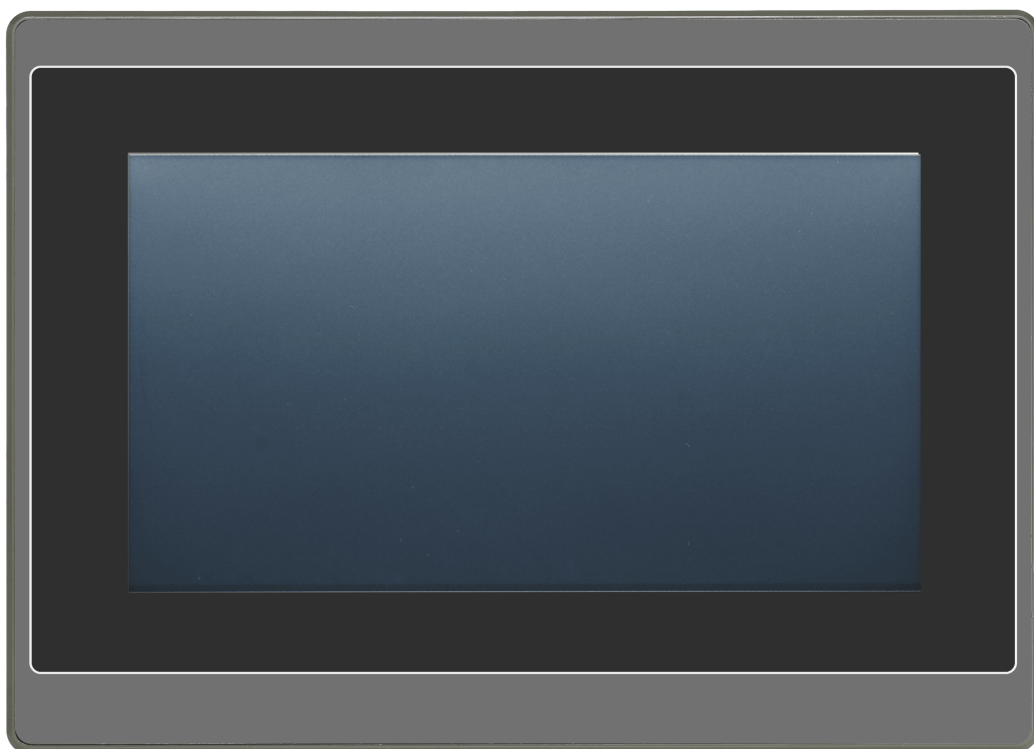



Power Supply / 電源供應 / 电源供应

⚠ Powered by a Low Voltage / Limited Energy power source.
以低電壓提供電力/限制能源電源 / 以低电压提供电力/限制能源电源

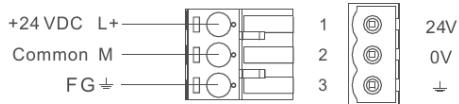

⚠ Do not open the rear cover of the panel when power is applied.
電源送電時請勿開啟後殼 / 电源送电时请勿开启后壳

⚠ Be sure that the power supply has enough power capacity for the operation of the equipment.
送電時請確定電源設備的電源能力符合產品硬體規範。
送电时请确定电源设备的电源能力符合产品硬件规范。

· PT2070-WST / PT2080-TST / PT2100-WST: 24VDC±10% / 0.8A

Dispose of batteries / 電池處置 / 电池处置



⚠ Dispose of batteries according to local regulations.
廢棄電池的處置請依據使用者所在地之規範辦理廢棄電池處置方式。 /
废弃电池的处置请依据使用者所在地对废弃电池处置方式办理。

5

Connections / 腳位圖 / 脚位图

Type B	COM1 & COM3 DB-9-Female / DB-9 母座 / DB-9 母座	Pin Description	
		Pin	Description
		1	RS422 TXD+ / RS485 + (COM1)
		2	RS232 RXD (COM1)
		3	RS232 TXD (COM1)
		4	RS422 RXD+ (COM1)
		5	SG
		6	RS422 TXD- / RS485 - (COM1)
		7	RS232 TXD (COM3)
		8	RS232 RXD (COM3)
		9	RS422 RXD- (COM1)

COM2		Pin Description	
5 Pin Terminal / 5 Pin端子台 / 5 Pin端子台		Pin	Description
		1	RS-232
		5	RS-485

Type A (選購/選購/ Optional)	COM1 & COM3 DB-9-Female / DB-9 母座 / DB-9 母座	Pin Description	
		Pin	Description
		1	RS422 TXD+ / RS485 + (COM1)
		2	RS232 RXD (COM1)
		3	RS232 TXD (COM1)
		4	RS422 RXD+ (COM1)
		5	SG
		6	RS422 TXD- / RS485 - (COM1)
		7	RS232 TXD (COM3)
		8	RS232 RXD (COM3)
		9	RS422 RXD- (COM1)

COM2		Pin Description	
5 Pin Terminal / 5 Pin端子台 / 5 Pin端子台		Pin	Description
		1	RS-422
		5	RS-485

6

PT2070-WST/PT2080-TST/PT2100-WST
Human Machine Interface /
PT2070-WST/PT2080-TST/PT2100-WST 人機介面 /
PT2070-WST/PT2080-TST/PT2100-WST 人機界面

Outlet Dimension / 外觀尺寸 / 外觀尺寸

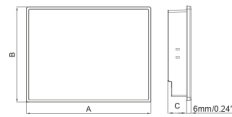

Cut Out Dimension / 開孔尺寸 / 開孔尺寸



Model	A	B	C	L	H
PT2070-WST	189.6mm/7.46"	144.3mm/5.70"	*30.3mm/1.19"	175mm/6.89"	132.5mm/5.22"
PT2080-TST	233mm/9.17"	176mm/6.93"	42.2mm/1.66"	221mm/8.70"	163.5mm/6.44"
PT2100-WST	270.8mm/10.66"	212.8mm/8.38"	42.5mm/1.67"	259mm/10.2"	201mm/7.91"

*Without COM Port & Terminal Block Height / 不包含COM2 5Pin 端子 / 不包含COM2 5Pin 端子

1

Function View / 功能配置圖 / 功能配置圖

PT2070-WST

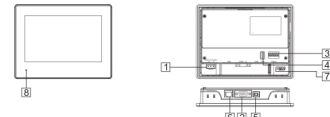

PT2080-TST

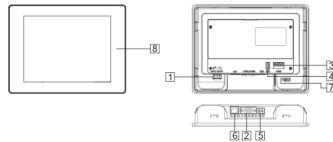

PT2100-WST

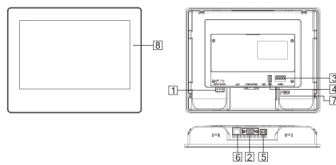

(Please refer to page 4 for the description of each function / 各功能說明請參閱第4頁 / 各功能說明請參閱第4頁)

3

Installation Drawing / 安裝示意圖 / 安裝示意圖

Plastic Locks / 塑膠安裝鎖具 / 塑膠安裝鎖具

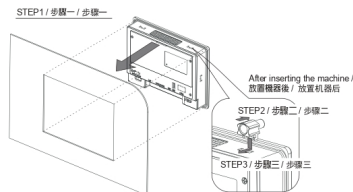

Metal Locks / 金屬安裝鎖具 / 金屬安裝鎖具

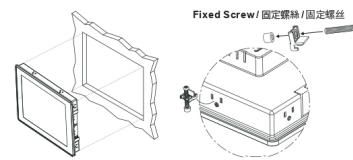

Tighten each fixing screw until the bezel corner gets in contact with the panel.
使用固定螺絲固定時請注意不要鎖太緊，以免壓扁面板或其他問題。
使用固定螺絲固定時請注意不要鎖太緊，以免壓扁面板或其他問題。
Suggested torque for fixing screws: 0.25-0.3Nm / 固定螺絲扭力建議值: 0.25-0.3Nm

2

The Other Type of Rear Case / 電池蓋後殼模型 / 電池蓋後殼模型

PT2070-WST / PT2080-TST / PT2100-WST

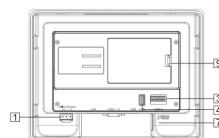

- 1 Power Connector / 電源端子 / 電源端子
- 2 COM1&3 9Pin Female / COM1&3 9Pin 母座 / COM1&3 9Pin 母座
- 3 COM2 5Pin Terminal / COM2 5Pin 端子台 / COM2 5Pin 端子台
- 4 USB Host / USB 主接口 / USB 主接口
- 5 USB Client / USB 從接口 / USB 從接口
- 6 Ethernet Port / 乙太網路 / 乙太網路
- 7 Micro SD Slot / Micro SD 插槽 / Micro SD 插槽
- 8 Power LED / 電源燈 / 電源燈
- 9 Battery Cover / 電池蓋 / 電池蓋

4